

# KERTEMINDE BYSKOLE

**Kerteminde Byskole**  
 Nørregade 21, 5300 Kerteminde  
 kertemindebyskole@kerteminde.dk  
 Tlf. 6515 1800  
 CVR.: 29189706  
 Direkte  
 tlf.nr. til SFO: 6515 1821

**Sekretærer:**  
 Ilse Lil Brønnum  
 tlf. 6515 1804 eller 2939 4938  
 ibb@kerteminde.dk

**Marlene Dinesen**  
 tlf. 6515 1800 eller 2928 5582  
 mdi@kerteminde.dk

**Teknisk service:**  
 Michael Bang Bentzen  
 tlf. 6515 1808 eller 2134 1269  
 mcb@kerteminde.dk

**Viceskoleleder og afdelingsleder  
 for udskolingen:**  
 Claus Toft Christensen  
 tlf. 6515 1805 eller 4055 5231  
 ctc@kerteminde.dk

**Afdelingsleder - indskolingen & SFO:**  
 Birgit Holton  
 tlf. 6515 1820 eller 4022 7758  
 boh@kerteminde.dk

**Afdelingsleder - mellemtrinnet:**  
 Jette Møller  
 tlf. 6515 1803 eller 2374 8480  
 jml@kerteminde.dk

**Skoleleder:**  
 Jesper Bech Madsen  
 tlf. 6515 1801 eller 2927 0163  
 jbm@kerteminde.dk

## 2. sal

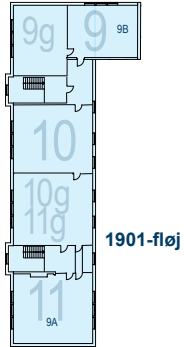

## 1. sal

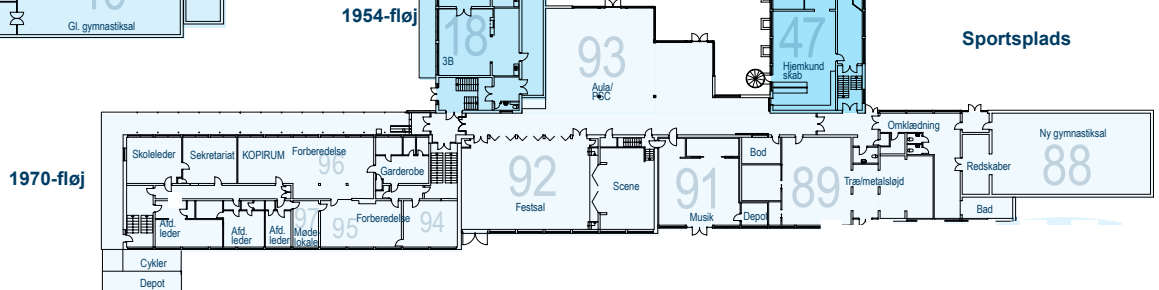
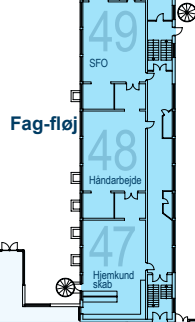
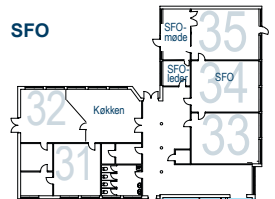
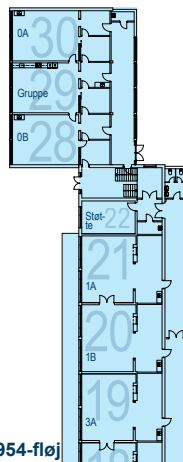
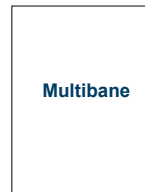
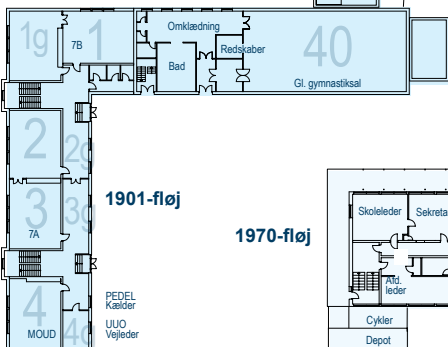
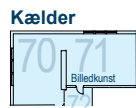
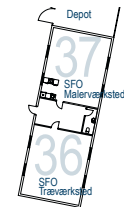
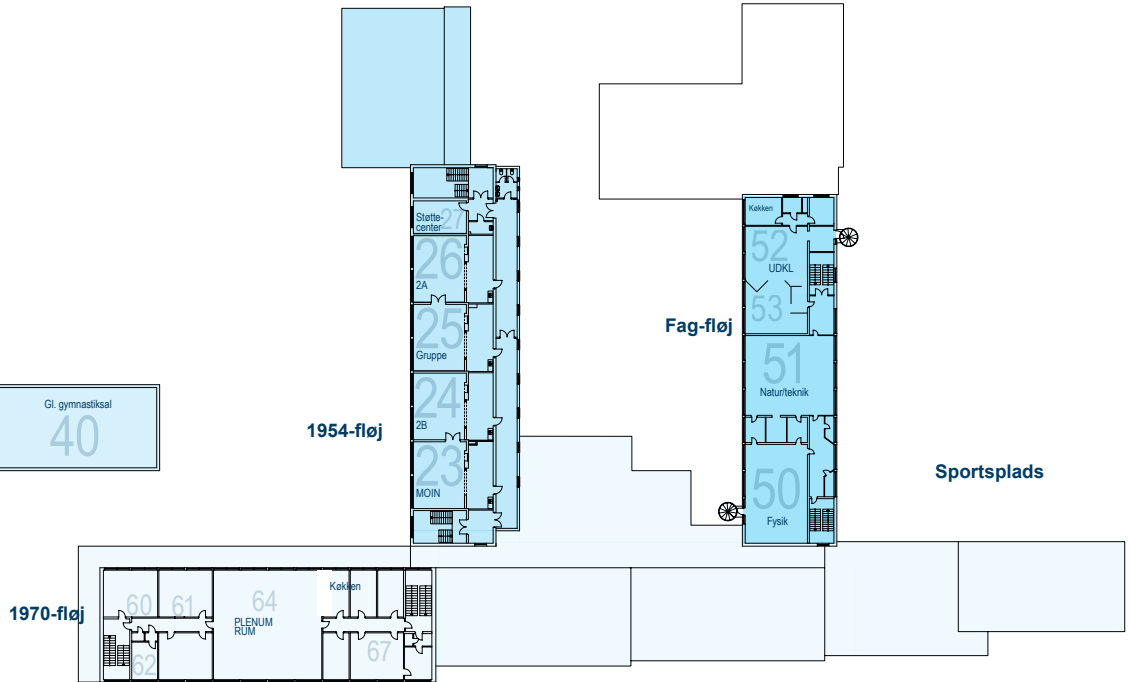
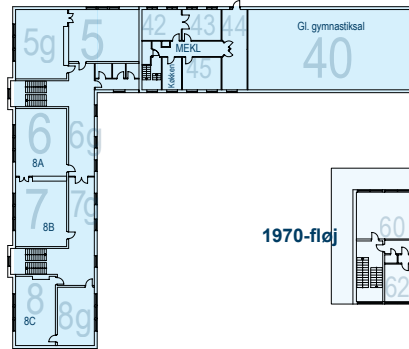

## Stuen

